



SARGENT®

30 SERIES
EXIT DEVICES

Table Of Contents	Page
Features, Applications and UL Fire Door Ratings	1
Vertical Rod Type Exit Device	2
Rim Type Exit Device	3
Trim Packs for 3727 and 3728 Exit Devices	4
Alternate Strikes and Shim Kits	5
Accessories - Mullions and Door Kits	6
General Information	7
Architectural Specifications and How To Order	8

On The Cover

- SARGENT 3828 Rim Exit Device with EN Finish

Applications

Features

- Rugged exit device in surface vertical rod and rim designs
- Chassis mounted unit construction assures easy installation and maintenance
- Tapered push rail and angled covers
- Steel endcaps and covers
- Available in four different functions with various trim selections
- UL Listed
- UL Listed to Canadian safety standards
- Available as Fire Exit Hardware (12-)

Single Door

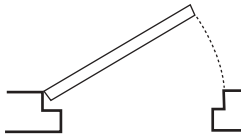

Vertical Rod Type 3727
Surface applied 2 point lock.
Rim Type 3828
Surface application.

Pairs of Doors without Mullion

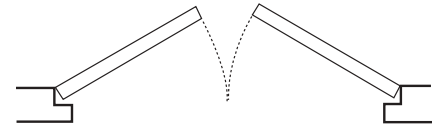

Vertical Rod Type 3727 - 2 Each
Surface applied 2 point locking both doors.
Each door active. Do not use an overlapping astragal.

Pairs of Doors with 980 Mullion

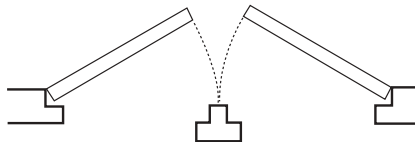

Rim Type 3828 - 2 Each
980 Mullion - 1 Each
Two independent active doors with full double door opening when required.

Pairs of Doors without Mullion

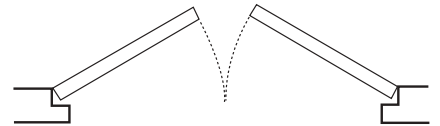

Vertical Rod Type 3727 - 1 Each
Rim Type 3828 - 1 Each
Both devices are surface applied.
A coordinator is recommended.

Maximum Door Openings & UL Fire Door Ratings

For available functions and outside trim, see charts for regular exit devices

Application & Type	Regular Design	Maximum Door Opening	UL Fire Door Rating				
			(A) 3 Hour	(B) 1 1/2 Hour	(C) 3/4 Hour	(D) 1 1/2 Hour	(E) 3/4 Hour
Single Doors Rim Type	12-3828	4'0" X 8'0" 1219mm X 2438mm	•	•	•	•	•
Pair of Doors Two Surface Mounted Vertical Rod Type - Swinging in same direction - No astragal - No coordinator	* 12-3727	8'0" X 8'0" 2438mm X 2438mm	•	•	•	•	•
Two Rim Type with 12-980 Mullion	12-3828 x 12-3828	8'0" X 8'0" 2438mm X 2438mm	•	•	•	•	•
Two Surface Mounted Vertical Rod Type -Swinging in opposite directions	12-3727 x 12-3727	8'0" X 8'0" 2438mm X 2438mm	•	•	•	•	•

*Limited for fire doors listed by UL for this use. NFPA requires an astragal on 3 hour applications.
Vertical rod application will not work with astragal.

3727 Series Exit Devices Vertical Rod Type

SARGENT
1-800-727-5477

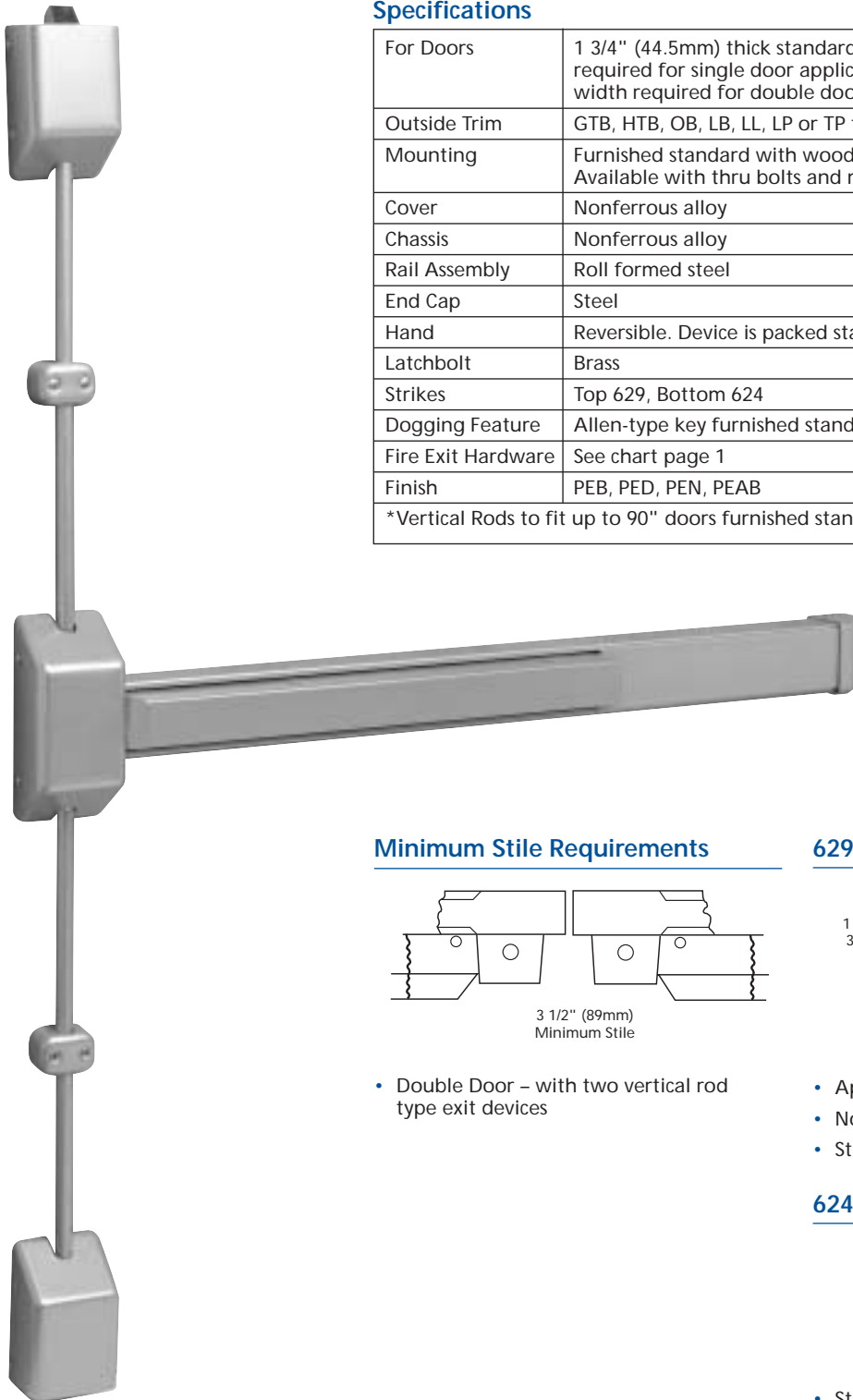

Specifications

For Doors	1 3/4" (44.5mm) thick standard. 3 3/4" (95mm) minimum stile width required for single door application. 3 1/2" (89mm) minimum stile width required for double door application
Outside Trim	GTB, HTB, OB, LB, LL, LP or TP trim available
Mounting	Furnished standard with wood and machine screws Available with thru bolts and mortise nuts
Cover	Nonferrous alloy
Chassis	Nonferrous alloy
Rail Assembly	Roll formed steel
End Cap	Steel
Hand	Reversible. Device is packed standard LHRB
Latchbolt	Brass
Strikes	Top 629, Bottom 624
Dogging Feature	Allen-type key furnished standard
Fire Exit Hardware	See chart page 1
Finish	PEB, PED, PEN, PEAB
*Vertical Rods to fit up to 90" doors furnished standard. 84" doors on Turboship	

Minimum Stile Requirements

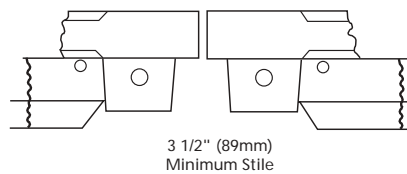

- Double Door – with two vertical rod type exit devices

629 Top Strike

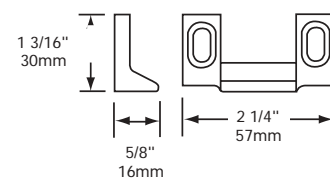

- Applied to surface of stop
- No mortise required
- Strikes are black nylon coated

624 Bottom Strike

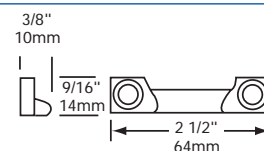

- Standard for 3727. Applied to surface of floor or to a flat threshold
- Strikes are black nylon coated

3828 Series Exit Devices Rim Type

SARGENT
1-800-727-5477

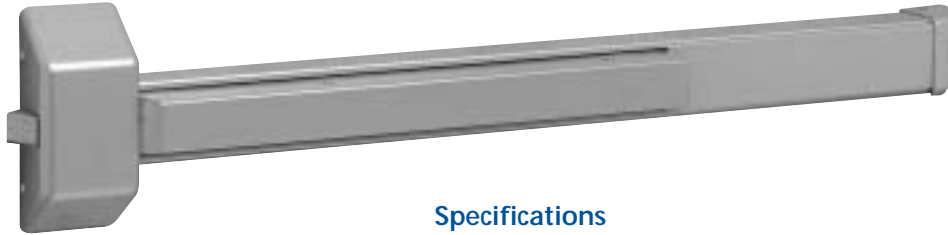

Specifications

For Doors	1 3/4" (44.5mm) thick standard. 4 1/2" (114mm) minimum stile width required for single or double door application using standard 641 strike
Outside Trim	GTB, HTB, OB, LB, LL, LP or TP trim available
Mounting	Furnished standard with wood and machine screws Available with thru bolts and mortise nuts
Cover	Nonferrous alloy
Chassis	Nonferrous alloy
Rail Assembly	Roll formed steel
End Cap	Steel
Hand	Non handed
Latchbolt	Stainless Steel 3/4" (19mm) throw
Cylinder	Brass. 6-pin standard. Rim type
Strike	641 packed standard
Dogging Feature	Allen-type key furnished standard
Fire Exit Hardware	See chart page 1
Finish	PEB, PED, PEN, PEAB

641 Strike

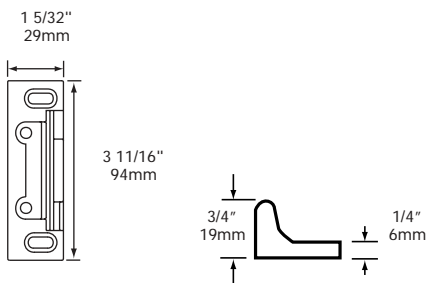

- Standard strike. Surface applied
- Strikes are black nylon coated

Minimum Stile Requirements

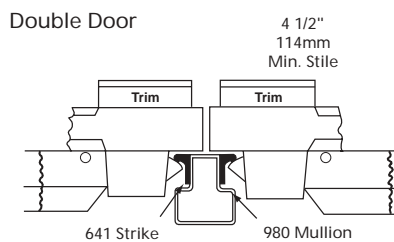

Minimum Stile Requirements

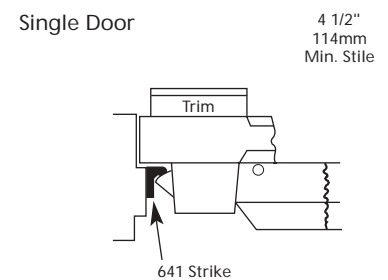

30 Series Exit Devices Trim Packs for 3727 and 3828

SARGENT
1-800-727-5477

Trim packs contain a lever, knob, thumbpiece, pull or cylinder as required by function. A trim is combined with either a 3727 or 3828 exit device to make the function required. All trims packed separate from exit device.

GTB Designs

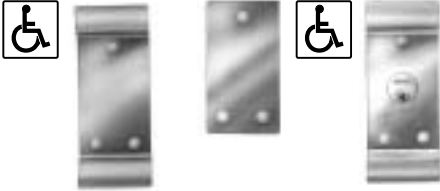

28-D-GTB 28-E-GTB 28-K-HTB

Trim is furnished with 3 mortise nuts and screws for 1 3/4" (44.5mm) doors standard. Also available for up to 2 1/4" (57mm) doors. Pulls project 1 1/2" from door face. GTB Design trim will cover a 161 cutout. If cylinder operation is required without trim, order 3828 x 34 rim cylinder.

Finishes: PEN, PEB, PED, PEAB

OB Design



For 1 3/4" (44.5mm) doors only. Available for 3727 and 3828 devices for 04, 13 and 15 functions. Not handed.

Finishes: 3, 10, 10B, 26, 26D

To order, specify trim for function required.

Example: 28-C-OB x 26D
Key in knob locks/unlocks knob.
Trim ordered separately.

Lever Design



For 1 3/4" (44.5mm) doors only. Available for 3727 and 3828 devices for 04, 06, 10, 13 and 15 functions. Not handed.

Finishes: 3, 10, 10B, 26, 26D. Lever designs available: "L", "B", "P"

To order, specify trim for function required.

Example: 28-K-LL x 26D x US3
Key in lever retracts latchbolt.

Trim ordered separately.

3727/3828 Thumbpiece Trim



*1 3/4" Door Only

28-C-TP	Key locks or unlocks thumbpiece	(63)
28-K-TP	Key retracts latchbolt	(04)
28-L-TP	Thumbpiece always operable	(62)
28-D-TP	Dummy trim	(10)

3727/3828 Trim Packs

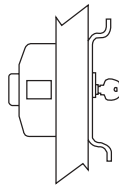

28-K-HTB (Shown)

Outside by pull and key.
(3828 only)

04 Function

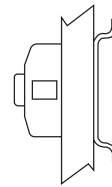

28-D-GTB

Outside pull when push bar is locked down.
(3727 & 3828)

10 Function

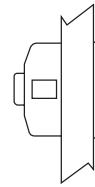

28-E-GTB

Blank plate to cover 161 cutout.
(3727 & 3828)

10 Function

3727/3828 Knob Trim

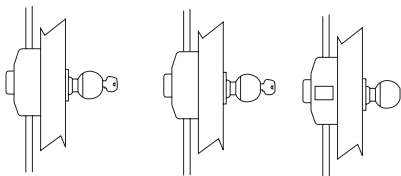

28-K-OB

Key in knob retracts latchbolt.

04 Function

28-C-OB

Key in knob locks or unlocks knob.

13 Function

28-L-OB

Latchbolts operated by knob.

15 Function

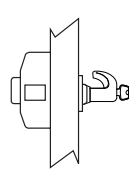

28-K-LL

Key in lever retracts latchbolt.

04 Function
(For 3828 only)

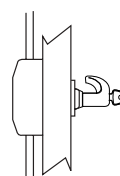

28-N-LL

Lever operates only when key is in cylinder and turned.

06 Function

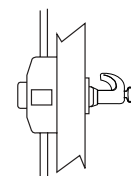

28-C-LL

Key in lever locks or unlocks lever.

13 Function

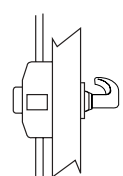

28-L-LL

Latchbolt operated by lever.

15 Function

3727/3828 Lever Trim

30 Series Exit Devices Accessories—Alternate Strikes and Shim Kits

SARGENT
1-800-727-5477

Alternate Strikes

613 Strike

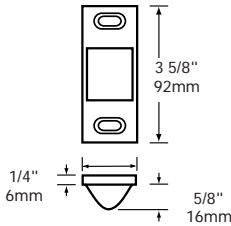

Half mortised. Nylon coating on face plate only. Minimum stile 4". Specify finish when ordered separately.

636 Strike

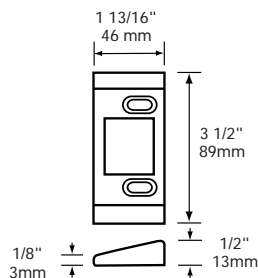

Alternate for 3727 requires mortise in floor.

644 Strike

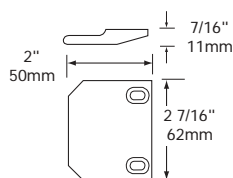

Surface applied. For use on pair of doors without mullion. Specify finish when ordered separately.

642 Strike

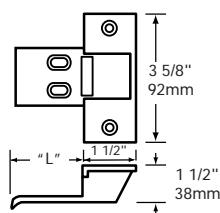

Full mortised Dimension "L" equals door thickness plus 1/2". Specify finish. Nylon coating on lip only.

Fire Exit Hardware Strikes

646 Top Strike

For 12-3727.
Surface applied.

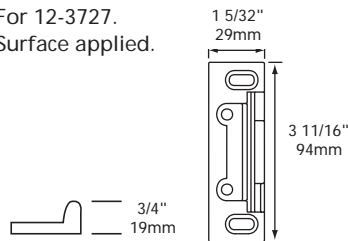

649 Strike

For 12-3828. Surface applied.

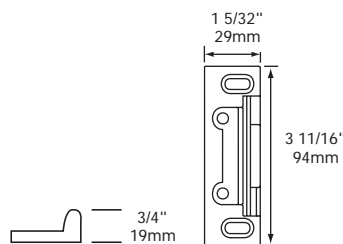

653 Bottom Strike (Alternate)

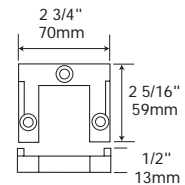

Available on order for 12-3727. For use with 1/2" (13mm) high threshold. Cut threshold to fit strike. Stainless steel. Furnished with expansion shields.

655 Bottom Strike

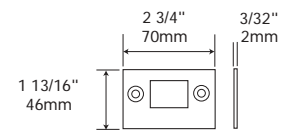

For 12-3727. Flush mounting stainless steel. Furnished with expansion shields.

Glass Bead Shim Kits

558 for 3828 and 12-3828 Exit Devices

559 for 3727 and 12-3727 Exit Devices

Note: When ordering shim kits for exits with outside trim, spindle length, thumbpiece length and thru bolt length must be increased accordingly.

(2 pieces 1/8" shim supplied. 1/4" total.)

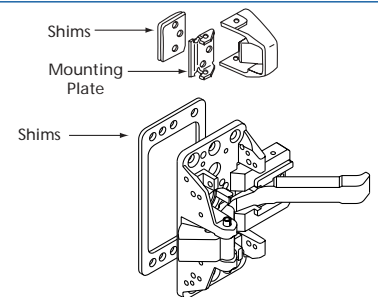

Thru Bolt (TB) Applications

Device	Door Thickness	*Ordering Number
3727	1 3/4" (44.5mm)	28-2031
	2 1/4" (57mm)	28-2032
12-3727	1 3/4" (44.5mm)	28-2078
	2 1/4" (57mm)	28-2088
3828 & 12-3828	1 3/4" (44.5mm)	28-2024
	2 1/4" (57mm)	28-2025

*Specify finish

Thru bolts and mortise nuts are furnished in a pack with an instruction sheet according to the type of device for which they will be used.

To order thru bolts and mortise nuts with an exit device, add suffix TB to trim pack.

Example: 3727 x TB x PEN

Available finishes: PEB, PEN, PED, PEAB

To order thru bolt and mortise nut packs separately, see chart above.

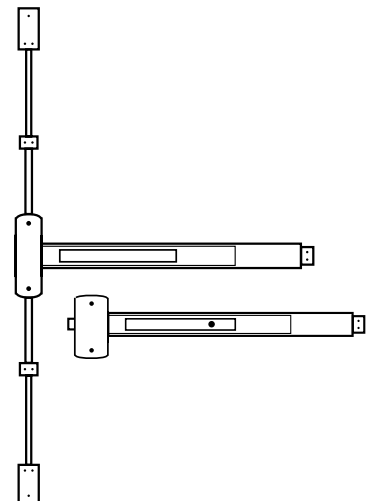

30 Series Exit Devices Accessories–Mullions and Door Kits

SARGENT
1-800-727-5477

980 Removable Mullion

980 Extruded Aluminum (prime coat)
980A Aluminum (US28)

Consists of:

- Mullion
- 511 Top Retainer
- 502 Bottom Retainer
- 96" (2438mm) stock size
- Up to 120" (3000mm) size avail.

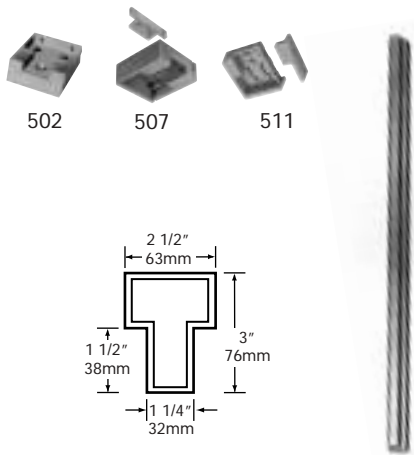

12-980 Mullion (96" maximum)

For 12-3828

2" x 3" Channel Iron. Malleable iron top and bottom retainers. Standard length 96" (2438mm). Lengths from 97" to 120" (3000mm) do not carry U.L. fire label.

98-2312

Top and bottom retainer pack.

Top Retainer 98-2190



Bottom Retainer 98-2191



L980 Lockable Mullion

- Aluminum Prime Coat
- Used for non fire rated applications, exterior openings
- 96" (2438mm) stock size
- 120" (3000mm) available
- All cylinder prefixes available

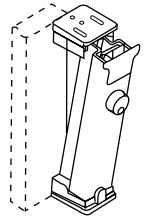

L980A Lockable Mullion

- Anodized aluminum
- Non fire rated applications only
- 96" (2438mm) stock size
- 120" (3000mm) available
- All cylinder prefixes available

12-L980 Lockable Mullion

- Steel
- Fire rated for 8'0" x 8'0" (2438mm x 2438mm) paired openings
- 96" (2438mm) stock size
- 120" (3000mm) available
- All cylinder prefixes available

507 Adapter for Narrow Transom Bars

- Required when soffit is 1 1/4" (32mm) to 2" (51mm) wide.

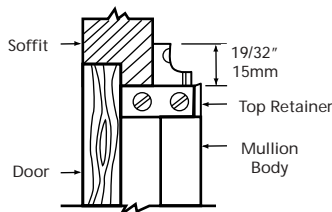

543 Stock Hollow Metal Door Kit

Kit consists of a 641 Strike Shim, a 161F Lock Front Filler, and a 86S Strike Filler for applying a 3828 Series Exit Device on doors prepared with Fed. Type 161 cutouts, and frames prepared for A.N.S.I. A115-2 Strikes.

The 641 strike shim is 1/8" (3mm) thick and is used to obtain the correct distance between the exit device case and the 641 surface applied strike, when the stop is 1/2" (13mm) high.



641
Strike
Shim



161
Lock Front
Filler



86S
Strike Filler

EL980 Electric Lockable Mullion

- Steel
- For use with monitor or electric strikes
- Quick-Connect wiring supplied
- 96" (2438mm) stock size
- 120" (3000mm) available
- All cylinder prefixes available
- Not available in 12- prefix

Mullion Accessories

RK980

Latchbolt assembly retrofit kit with top and bottom retainers for 980 mullion

Retainer Packs

Product #	Description
98-2526	Top Ret. Pack for L980
98-2525	Bottom Ret. pack for L980
98-2558	Top Ret. Pack for 12-L980
98-2556	Bottom Ret. pack for 12-L980
98-2559	Top Ret. Pack for EL980

30 Series Exit Devices General Information

SARGENT
1-800-727-5477

Check List for Ordering

Indicate the following door and frame information:

- Single doors, or pair of doors with mullion, or pair of doors without mullion.
- Door and frame material.
- Dimensions:
 - Door opening width
 - Stile width
 - Door thickness
 - Stop height

Example: Single Door x Hollow Metal Frame 36" x 5" x 2 1/4" x 1/2"

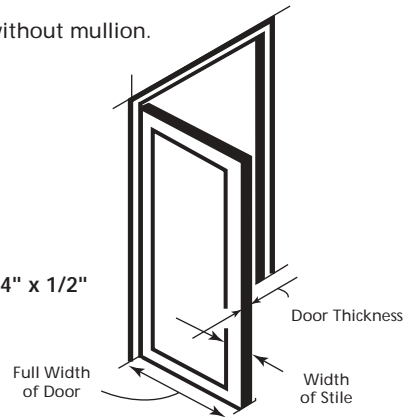

- If Vertical Rod Devices also indicate:
 - Mounting height
 - Door opening height
 - Threshold height
 - If no threshold is used, so state
 - Unless threshold information is indicated, exit device will be furnished for use without threshold.
- In ordering mullions (if other than stock 96" height) indicate height from finished floor to underside of stop.
- In ordering templates for hollow metal doors and/or frames, state job name on template order. Give template order number or template numbers on hardware order.

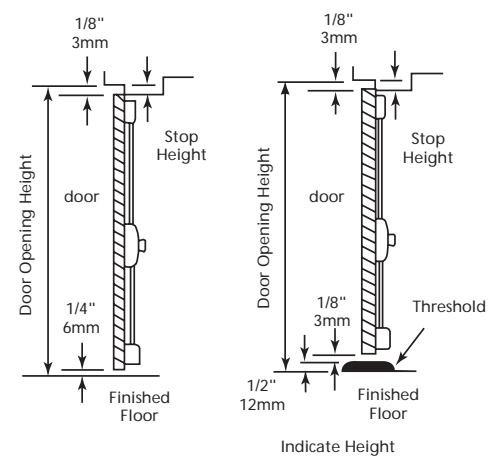

Stock Rail Sizes Available

E	For doors 24" thru 32"	61cm thru 81cm
F	For doors 32 1/4" thru 36"	82cm thru 91cm
G	For doors 36 1/4" thru 48"	92cm thru 122cm
The F size device is the standard stock size. Device can be cut to size in the field.		

Packaging

Product	Avg. WT	Case
Exit with trim	15 lbs.	1 ea
980 mullion	18 lbs.	1 ea
12-980 mullion	40 lbs.	1 ea

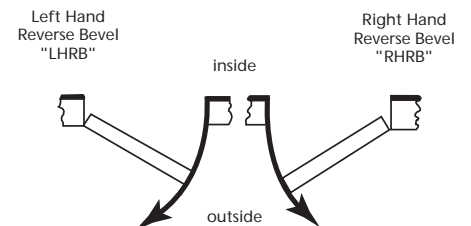

30 Series Exit Devices Architectural Specifications–How To Order

SARGENT
1-800-727-5477

Prefixes Available

10	SARGENT Signature Key system
10-UL	SARGENT Signature Cylinder meeting UL437 (Mortise & Rim Cylinders only)
12	UL fire label exit device
16	Cylinder lockdown feature
21	SARGENT Lost Ball Construction Key System
22	SARGENT Split Key Construction Key System (existing systems only)
*60	SARGENT removable disposable construction core
*63	SARGENT removable core cylinder
*64	SARGENT removable construction core cylinder
65-73	Arrow, Best, Falcon 6 pin uncombined core
65-73-P	Arrow, Best, Falcon 7 pin uncombined core
*70	Arrow, Best, Falcon interchangeable cores. Disposable plastic construction core cylinder.
*72	Arrow, Best, Falcon interchangeable 6 pin construction core cylinder
*73	Arrow, Best, Falcon interchangeable 6 pin core cylinder
*73-7P	Arrow, Best, Falcon interchangeable 7 pin core cylinder. Keyed to existing systems only.
SC	Schlage "C" Keyway Cylinder "0" Bitted
SE	Schlage "E" Keyway Cylinder "0" Bitted

*For Lever Trim Only

Finishes

Symbol	Description
PEN	Powder coated to match 26D
PEB	Powder coated to match 10B
PED	Powder coated to match 20D
PEAB	Powder coated to match 03/04

Suggested Architect's Specifications

- All exit devices shall be of touch bar design and be operative over 2/3 of the door's clear opening width
- All exit devices must be listed under "Panic Hardware" in the Accident Equipment List of Underwriter's Laboratories, Inc. Where labeled doors are used as exits, they must be equipped with labeled Fire Exit Hardware
- All springs shall be of stainless steel
- All exit devices shall be of chassis mounted unit construction with removable cover

How to Order Exit Device

Ex. 12-3828 x PEN		
Specify		
Prefix	Fire Exit Hardware	12-
Device Number	Rim Exit Device	12-3828
Rail Size	Specify Door Width	12-3828 x 36"
Finish	Specify	12-3828 x 36" PEN

How to Order Trim

Ex. 63-28-K-HTB x EAB		
Specify		
Prefix	Removable Core	63-
Trim	28-K-HTB	63-28-K-HTB
Finish	EAB	63-28-K-HTB X EAB



SARGENT Manufacturing Company • 100 Sargent Drive • P.O. Box 9725 • New Haven • CT 06536-0915
Phone: 800-727-5477 • Fax: 888-863-5054 • Web site: www.sargentlock.com
SARGENT of Canada • Phone: 905-940-2040 • Fax: 905-940-3242 • Web site: www.sargentcanada.ca

Founded in 1864, SARGENT® is a market leader in locksets, cylinders, door closers, exit devices, electro-mechanical products and access control systems for new construction, renovation and replacement applications. The company's customer base includes commercial construction, institutional and industrial markets.

The ASSA ABLOY Group is the world's leading manufacturer and supplier of locking solutions, dedicated to satisfying end-user needs for security, safety and convenience.